

Amorphous Core for Car Audio

1. Core Size

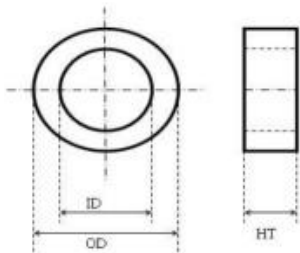

2. Case Size

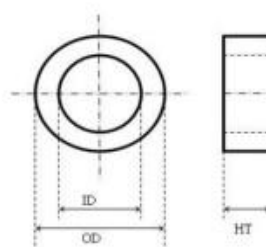

Part No.	Core Dimension	Finished Dimension	AL min. I _{dc} =0	N	I _{dc}	L _v min. I _{dc} =Rated
	(mm)	(mm)	(μH)	(Turns)	(A)	(μH)
FJ061005	6.5x9.8x4.5	5.1x11.2x5.9	0.12	50	0.3	150
FJ081205-1	8x12x4.5	6.3x13.8x6.5	0.1	50	1.5	160
FJ081205-2	8x12x4.5	6.3x13.8x6.5	0.19	38	1	100
FJ091505	8.5x15.3x5.0	7.4x16.8x6.3	0.21	36	1	240
					2	160
					3	50
FJ101608-1	10x16x8.0	8.3x18.2x10.3	0.13	40	2	150
FJ101608-2	10x16x8.0	8.3x18.2x10.3	0.21	46	2	300
FJ101608-3	10x16x8.0	8.3x18.2x10.3	0.5	20	1	150
FJ101608-4	10x16x8.0	8.3x18.2x10.3	0.62	27	1	300
FJ101608-5	10x16x8.0	8.3x18.2x10.3	0.85	32	0.5	500
FJ101905-1	10x18.5x5.0	8.0x20.8x6.8	0.26	35	2	230
FJ101905-2	10x18.5x5.0	8.0x20.8x6.8	0.35	43	1	500
					2	200
FJ111808-1	11x18x8.0	8.8x19.8x9.7	0.55	21	2	180
FJ111808-2	11x18x8.0	8.8x19.8x9.7	0.57	27	1.7	240
FJ111808-3	11x18x8.0	8.8x19.8x9.7	0.5	20	1	150
FJ111808-4	11x18x8.0	8.8x19.8x9.7	0.7	24	1	250
FJ111808-5	11x18x8.0	8.8x19.8x9.7	0.78	24	1	300
FJ111808-6	11x18x8.0	8.8x19.8x9.7	0.78	30	1	350
FJ111810-1	11x18x10	8.8x19.8x11.9	0.2	50	1	400
					2	350
					3	280
FJ111810-2	11x18x10	8.8x19.8x11.9	0.63	26	2	280
FJ111810-3	11x18x10	8.8x19.8x11.9	0.85	23	1	400
FJ122008-1	12x20x8.0	10.6x21.8x10	0.3	27	2	187
FJ122008-2	12x20x8.0	10.6x21.8x10	0.3	27	2	190
FJ122008-3	12x20x8.0	10.6x21.8x10	0.56	25	1	350
					2	100
FJ122010-1	12x20x10	10.6x21.8x12	0.84	21	1.5	250
FJ122010-2	12x20x10	10.6x21.8x12	0.84	28	1.8	280
FJ122406	12x24x6.5	/	0.39	30	2	300
FJ132210	13.2x21.5x10	11.5x24.0x12.9	0.9	23	1	400
FJ162508	16x25x8.0	14x27.2x10.8	0.09	21	1	25

Note: Customized Size is available.